

# NORTHWEST HALL

# NORTHEAST HALL

BOOTH COUNT	BOOTH SQ. FT.
8 x 10 - 97	7760
TOTAL SQ. FT.:	7760

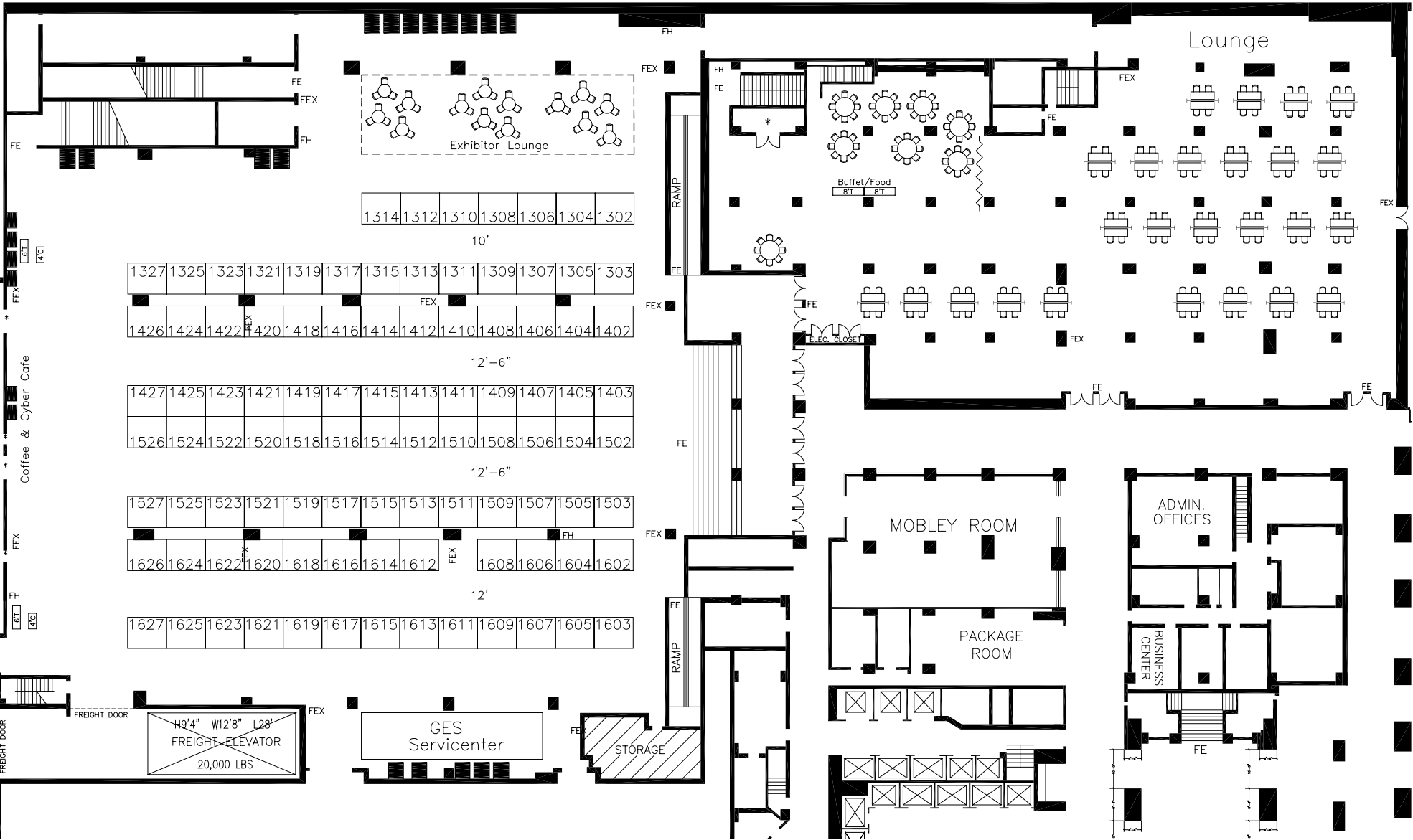

**GES.**

COPYRIGHT © BY GES EXPOSITION SERVICES. ALL RIGHTS RESERVED. NO PART OF THIS PUBLICATION MAY BE REPRODUCED, STORED IN ANY RETRIEVAL SYSTEM, OR TRANSMITTED IN ANY FORM OR BY ANY MEANS - ELECTRONIC, MECHANICAL, PHOTOCOPYING, RECORDING, OR OTHERWISE - WITHOUT THE EXPRESS WRITTEN CONSENT OF GES EXPOSITION SERVICES. EVERY EFFORT HAS BEEN MADE TO INSURE THE ACCURACY OF ALL INFORMATION CONTAINED ON THIS FLOOR PLAN. HOWEVER, NO WARRANTIES, EITHER EXPRESSED OR IMPLIED, ARE MADE WITH RESPECT TO THIS FLOOR PLAN. IF THE LOCATION OF BUILDING COLUMNS, UTILITIES, OR OTHER ARCHITECTURAL COMPONENTS OF THE FACILITY IS A CONSIDERATION IN THE CONSTRUCTION OR USAGE OF AN EXHIBIT, IT IS THE SOLE RESPONSIBILITY OF THE EXHIBITOR TO PHYSICALLY INSPECT THE FACILITY TO VERIFY ALL DIMENSIONS AND LOCATIONS.

## International Studies Assn

### February 28-March 3, 2007

Chicago Hilton & Towers - NW Exhibit Hall

**CONFIDENTIAL PROPERTY OF GES**  
 File: lee-0702-hilch-nw.dwg  
 Plotted: Nov 08, 2006  
 By: ADAMW